

Lina GT 45 h

Data sheet

Details

- Fireplace insert, open on one side, minimal body depth
- 4545 – Height 45 cm
4551 – Height 51 cm
4557 – Height 57 cm
- Optional: Self-closing door
- Adjustable lower air washing
- Standard fire box inner lining: white smooth chamotte
- High-grade cast-iron dome, all parts can be moved, adjustable between 0 – 90°
- Overall height can be simply and quickly adjusted
- Easy to dismantle for transport

Technical data

| | |
|---|--------------|
| Nominal heat output | 5 kW |
| Thermal output range | 2.4 – 5.4 kW |
| Efficiency | >78% |
| Insulation thickness (with wall that does not need to be protected) (based on SILCA® 250KM) | 60 mm |
| Combustion air connector | Ø 125 mm |
| Recommend length of logs | 33 cm |
| Weight | 200 – 220 kg |
| Heat distribution through the viewing window | 30% |
| Heat distribution, convective output | 70% |

Data for chimney sweep according to DIN EN 13384 (closed operation)

Triple values with nominal heat output

| | |
|----------------------------|---------|
| Flue gas mass flow | 4.7 g/s |
| Flue gas temperature | 340 °C |
| Required delivery pressure | 12 Pa |

Triple values for calculating ceramic flues (wood fuel)

| | |
|---|-----------|
| Firing power | 13.2 kW |
| Flue gas mass flow | 11.9 g/s |
| Flue gas temperature upstream of the connecting surface | 347 °C |
| Required delivery pressure at the flue gas connector | 15 Pa |
| Combustion air requirement | 46.3 m³/h |
| Recommended flue length ¹ | 3.5 m |

Data for closed design

| | |
|--|--------|
| Minimum heat-emitting surface ² | 2.5 m² |
|--|--------|

¹The information regarding flue lengths is a recommendation and based on the calculation in accordance with TROL 2022 chapter 15. The calculation is based on a medium-heavy design and a flue ratio of 360 cm².

²Average value based on the storage time. Dependent on the material properties and the construction thickness. Mean specific heat distribution = approx. 500 W/m²

There may be modifications to the colour and technical details caused by ongoing developments; subject to errors and omissions. Dated: 01/2024



Lina GT 45 with guillotine front

Standard



Optional



Accessories



SMR



Energy efficiency class in accordance with (EU) 2015/1186



1. Federal Emissions Control Ordinance Stage 2



Lina GT 45 h

Dimensional drawing

Front view, scale 1:20

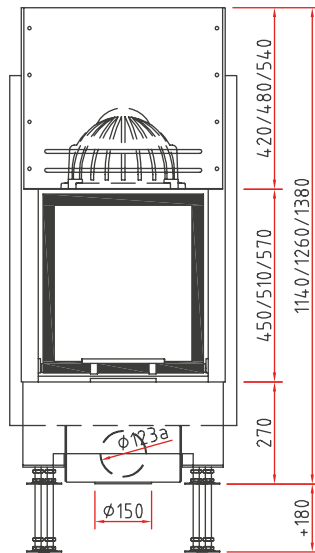

Side view, scale 1:20

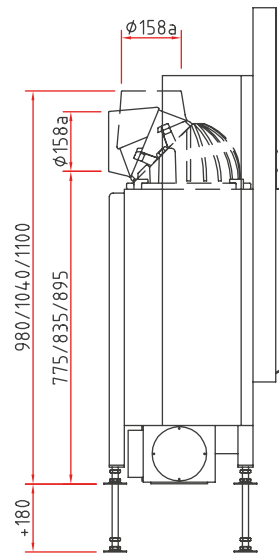

Top view, scale 1:10

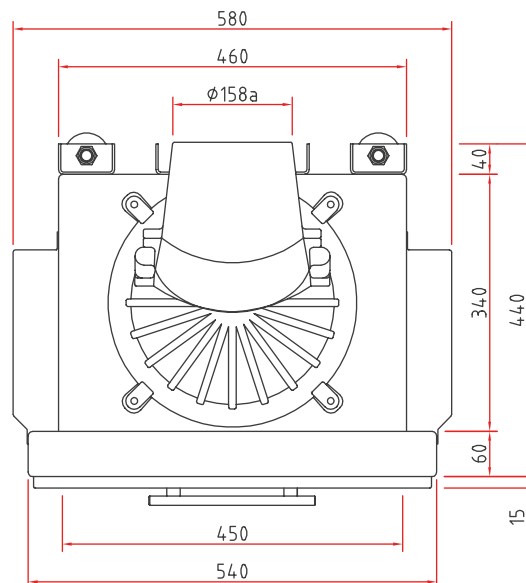

Lina GT 4551 h

Dimensional drawing with frame system

Front view, scale 1:20

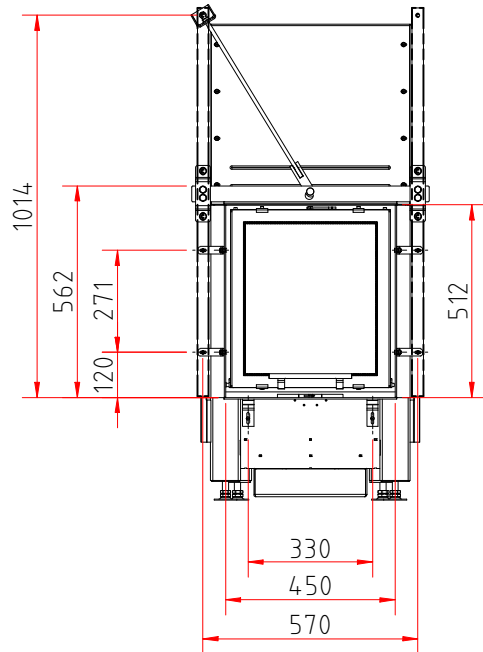

Side view, scale 1:20

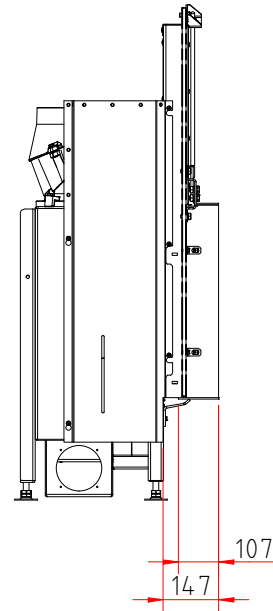

Top view, scale 1:10

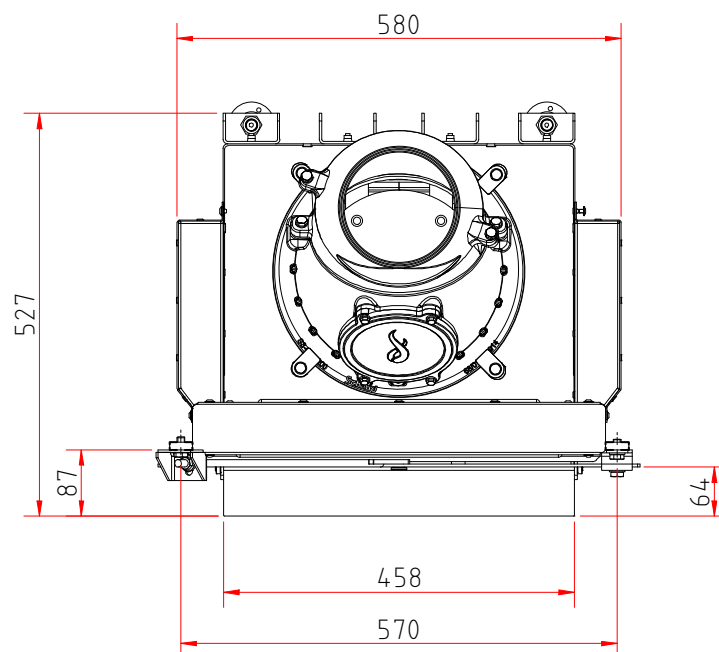

Product data sheet

Regulation (EU) 2015/1186 supplementing Directive 2010/30/EU

| | Lina 45 s/h GT |
|---|---|
| Supplier's name: | Camina & Schmid Feuerdesign und Technik GmbH & Co. KG |
| Supplier's model identifier: | Lina 45 s/h GT |
| Energy efficiency class: | A |
| Direct heat output (kW) | 5,0 |
| Indirect heat output (kW): | – |
| Energy efficiency index (EEI): | 103,2 |
| Energy efficiency at nominal heat output (%): | 78,1 |
| Notes for specific precautions, installation or maintenance: | Please note the reference in the assembly instructions and operating manuals! |

There may be modifications to technical details caused by ongoing developments; subject to errors and omissions. Dated: 11/2021



ENERG
енергия · ενέργεια



Camina  Schmid Lina 45 s/h GT

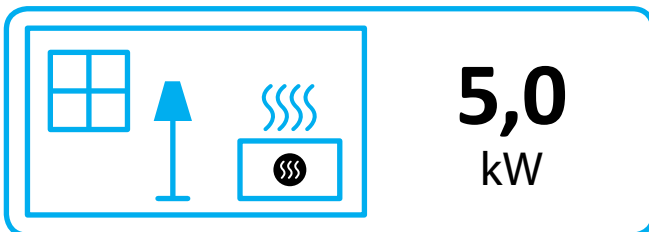
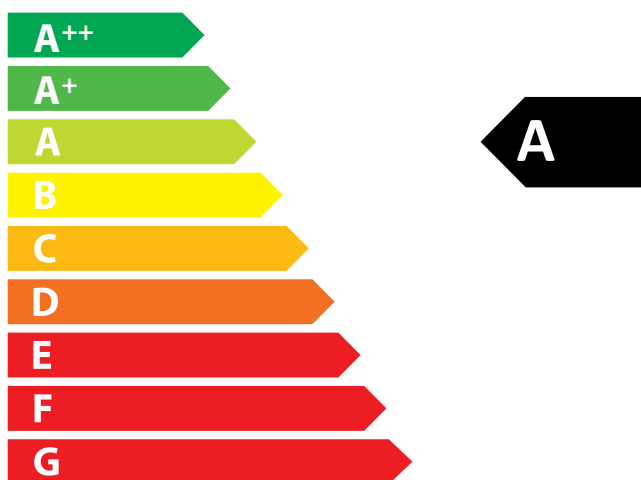

ENERGIA · ЕНЕРГИЯ · ΕΝΕΡΓΕΙΑ · ENERGIJA · ENERGY · ENERGIE · ENERGI

2015/1186